

ASSEMBLY INSTRUCTIONS MODEL 9890D

REMOVE ALL ITEMS FROM THE CARTON. VERIFY ALL PIECES BEFORE ASSEMBLY

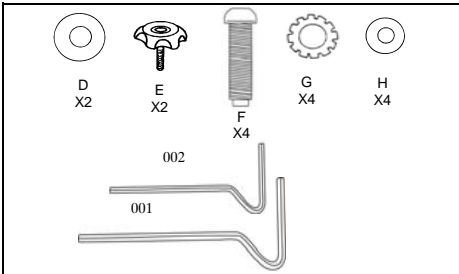
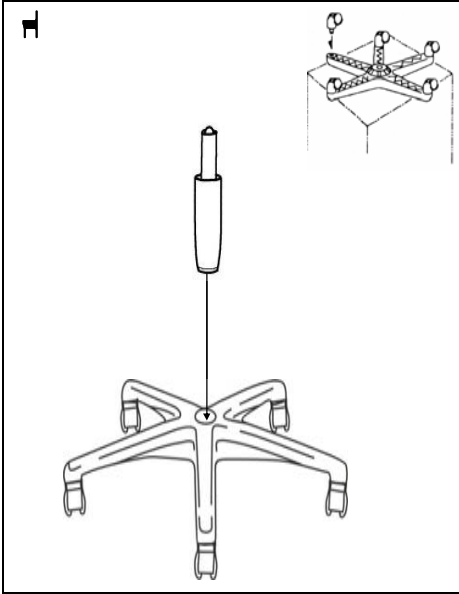

	QTY
D FLAT WASHER	2
E PLASTIC KNOB	2
F SCREW	4
G LOCK WASHER	4
H FLAT WASHER	4
001 ALLEN WRENCH FOR SCREWS(F)	1
002 ALLEN WRENCH FOR SCREWS FOR CHAIRWORKS NAME PLATE	1

PREVENTATIVE MAINTENANCE AND WARNING
 USE THIS PRODUCT ONLY FOR SEATING ONE PERSON AT A TIME
 DO NOT USE CHAIR AS STEP STOOL/LADDER
 DO NOT USE CHAIR UNLESS ALL BOLTS, SCREWS ARE TIGHT
 CHECK AND RETIGHTEN ALL BOLTS, SCREWS EVERY 6 MONTHS

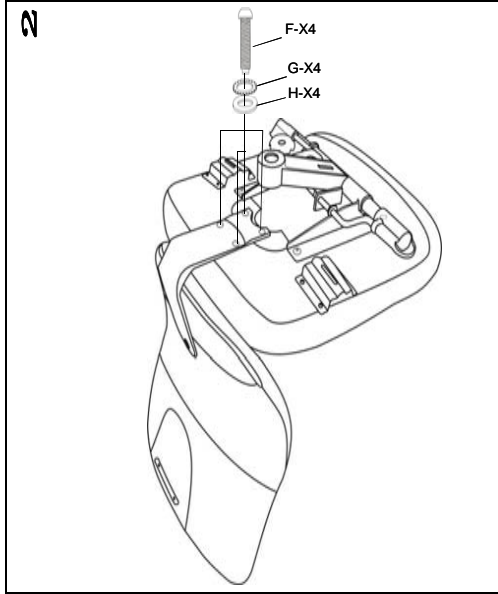

ANY QUESTIONS PLEASE CONTACT
 CHAIRWORKS AMERICA
 755 RACK DRIVE, SUITE A
 LAWRENCEVILLE, GA 30046
 1-888-217-2577

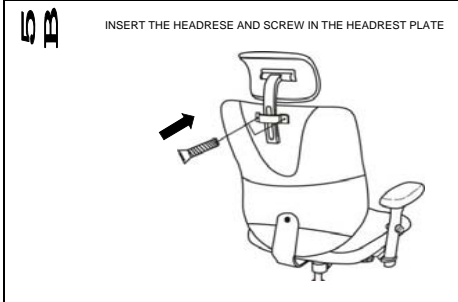
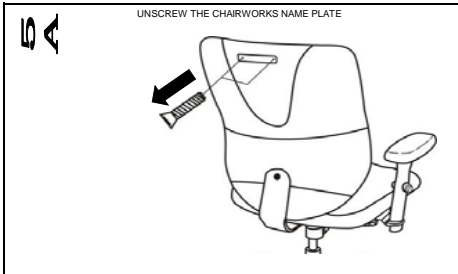
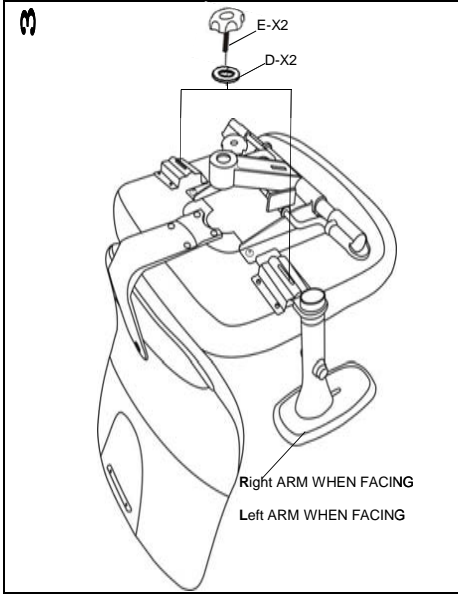

OPERATING INSTRUCTIONS
 A. SEAT HEIGHT ADJUSTMENT

TO RAISE THE SEAT:
 LEAN SLIGHTLY FORWARD WHILE SEATED TO RELIEVE THE PRESSURE ON THE TILT MECHANISM.
 REACH UNDER THE RIGHT SIDE OF THE CHAIR AND LOCATE THE HANDLE AND RAISE YOURSELF UP SLIGHTLY TO ALLOW THE CHAIR TO REACH YOUR DESIRED HEIGHT.
 TO LOWER THE SEAT:
 REMAIN SEATED AND LIFT THE HANDLE UPWARDS UNTIL THE CHAIR LOWER TO YOUR DESIRED HEIGHT.

B. TO ADJUST TILT LOCK MECHANISM:

PULL THE HANDLE ON THE LEFT OUT 1/2 INCH TO RELEASE THE LOCK. PUSH THE HANDLE ON THE LEFT IN 1/2 INCH TO LOCK THE TILT MECHANISM.

C. TILT TENSION ADJUSTMENT

TURN THE KNOB UNDERNEATH THE SEAT CUSHION CLOCKWISE FOR FIRMER/STIFFER TILT. TURN THE KNOB COUNTER CLOCKWISE FOR SOFTER/LOOSER TILT.

