

ASSEMBLY INSTRUCTIONS MODEL 9895J  
 REMOVE ALL ITEMS FROM THE CARTON. VERIFY ALL PIECES BEFORE ASSEMBLY

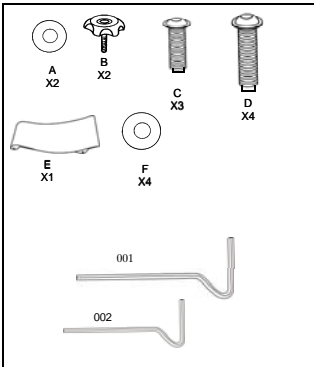

QTY

A	FLAT WASHER	2
B	PLASTIC KNOB	2
C	SCREW	3
D	SCREW	4
E	PLASTIC COVER	1
F	PLASTIC WASHER	4
001	ALLEN WRENCH FOR SCREWS(C,D)	1
002	ALLEN WRENCH FOR SCREWS FOR CHAIRWORKS NAME PLATE	1

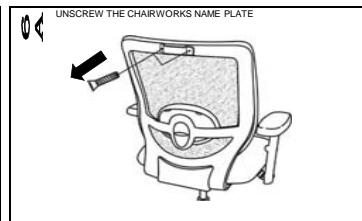
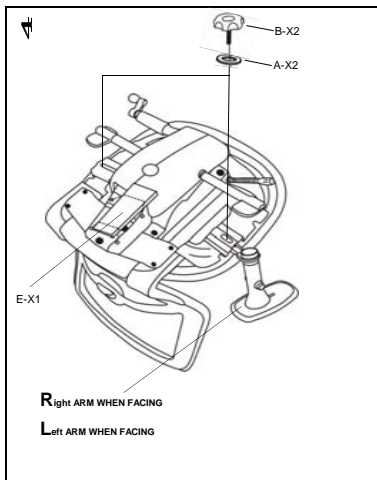
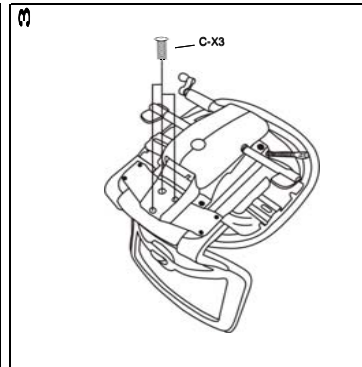
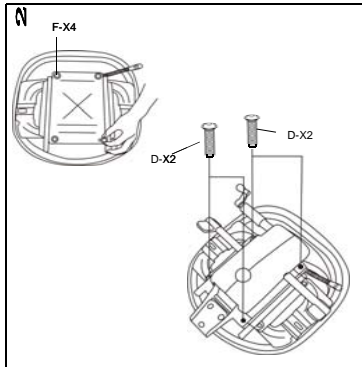
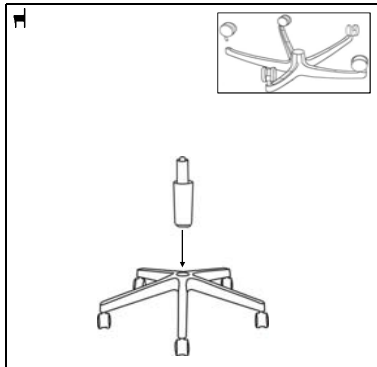

**OPERATING INSTRUCTIONS**

**A. SEAT HEIGHT ADJUSTMENT**  
 TO RAISE THE SEAT:  
 LEAN SLIGHTLY FORWARD WHILE SEATED TO RELIEVE THE PRESSURE ON THE TILT MECHANISM.  
 REACH UNDER THE RIGHT SIDE OF THE CHAIR AND LOCATE THE HANDLE AND RAISE YOURSELF UP SLIGHTLY TO UNTIL THE CHAIR LOWER TO YOUR DESIRED HEIGHT.

**B. TO ADJUST TILT MECHANISM:**  
 PULL THE HANDLE UPRIGHT, UNDER THE LEFT SIDE OF THE CHAIR, ALL THE WAY UP. THIS RELEASES THE LOCK, AND ALLOWS THE CHAIR TO MOVE FREELY (FROM FORWARD TILT TO RECLINE TILT).  
 PUSH THE HANDLE DOWN, & THEN TILT LOCK OUT LOCKS THE CHAIR IN EITHER FULLY UPRIGHT OR FULLY TILT POSITIONS (ONLY).  
 PUSHING THE HANDLE IN EITHER THE FULLY TILT OR THE FULLY UPRIGHT POSITION, LOCKS / RESTRICTS THE FREE TILT MOVEMENT.

**C. TILT TENSION ADJUSTMENT:**  
 GRASP THE ROUND CYLINDER KNOB UNDER THE FRONT CENTER SEAT PULL OUT.  
 FOR FIRMER/STIFFER-TURN CLOCKWISE.  
 FOR SOFTER/LOOSER-TURN COUNTER CLOCKWISE.  
**WHEN THE LOCK OUT IS RELEASED IN THE RECLINE POSITION, THE BACK WILL RETURN SLOWLY AND SAFELY - TO THE UPRIGHT POSITION.**

**D. SEAT SLIDING ADJUSTMENT**  
 ADJUST LEVER C (AS SHOWN ABOVE) UP TO POSITION SEAT AND THEN DOWN TO LOCK SEAT INTO POSITION. NOTE: BACK MUST BE IN LOCKED POSITION (D) TO USE SLIDING SEAT FEATURE

**HEADREST ADJUSTS**

**ARM ADJUSTS**

Labels for adjustments:  
 - ADJ HEADREST (UP/DOWN) + ANGLE ADJUST  
 - ARM PAD ADJUST FORWARD/BACK + L/R TWIST  
 - ARMREST HEIGHT ADJUST  
 - ARM WIDTH ADJUST  
 - SEAT HEIGHT ADJUST  
 - SEAT TILT TENSION ADJUST  
 - ADJ LUMBAR (IN/OUT)  
 - BACK ANGLE ADJUST  
 - FLOATING SYNCHRO MECH.

PREVENTATIVE MAINTENANCE AND WARNING  
 USE THIS PRODUCT ONLY FOR SEATING ONE PERSON AT A TIME  
 DO NOT USE CHAIR AS STEP STOOLLADDER  
 DO NOT USE CHAIR UNLESS ALL BOLTS, SCREWS ARE TIGHT  
 CHECK AND RETIGHTEN ALL BOLTS, SCREWS EVERY 6 MONTHS

ANY QUESTIONS PLEASE CONTACT  
 CHAIRWORKS AMERICA  
 755 RACK DRIVE, SUITE A  
 LAWRENCEVILLE, GA 30046  
 1-888-217-2577